

LEASE

\$18.00 SF/Year
Office Bldg
14,344 SF

Northwest Professional Center
17615 85th Ave Ct E
Puyallup, WA 98375



Property Type:	Office Bldg
Max Continuous Area:	12,767
Min Divisible Area:	1,388
Listing ID:	RML9MV
MLS ID:	594270
Style:	Office Bldg -General
Building Size:	14,344 SF

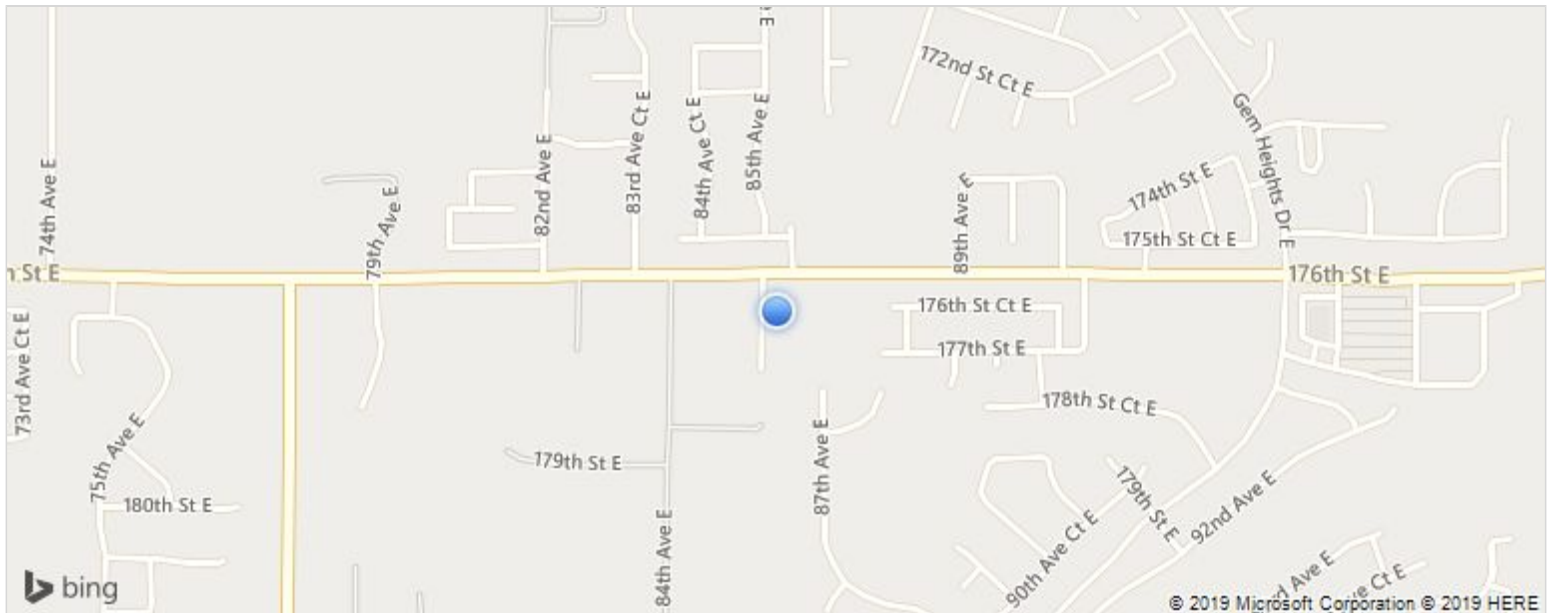

Northwest Professional Center - 17615 85th Ave Ct E Puyallup WA, 98375 United States

Online Profile <http://www.cbcworldwide.com/properties/profile/RML9MV-Puyallup-WA>

Property Description

Great drive up professional office space with frontage on busy 176th in Puyallup. Over 27,000 cars per day. Co-tenancy includes Northwest Chiropractic & Holmes Nutritional Health. All suites are ground floor. Monument signage available. 3-phase power in place for imaging equipment etc. Low NNN expenses. Separate metered for electricity. Great for dentist, medical, professional services.

Additional Features

Lot Size: 1.11 AC

Kim Adams

kimadams@cbcworldwide.com

Direct 206-949-8723

Mobile 206-949-8723



<http://www.cbcdanforth.com/>
253-874-3200

Danforth
33313 1st Way S
Federal Way, WA 98003

© 2019 Coldwell Banker Real Estate LLC, dba Coldwell Banker Commercial Affiliates. All Rights Reserved. Coldwell Banker Real Estate LLC, dba Coldwell Banker Commercial Affiliates fully supports the principles of the Equal Opportunity Act. Each Office is Independently Owned and Operated. Coldwell Banker Commercial and the Coldwell Banker Commercial Logo are registered service marks owned by Coldwell Banker Real Estate LLC, dba Coldwell Banker Commercial Affiliates. Each sales representative and broker is responsible for complying with any consumer disclosure laws or regulations.

The information provided is deemed reliable, but it is not guaranteed to be accurate or complete, and it should not be relied upon as such. This listing information should be independently verified before any person enters into a transaction based upon it.